

WALL HANGING BRACKET POSITIONS

Wall Bracket Type 'A' "Snap in 2"
Used with base, wall and tower units.

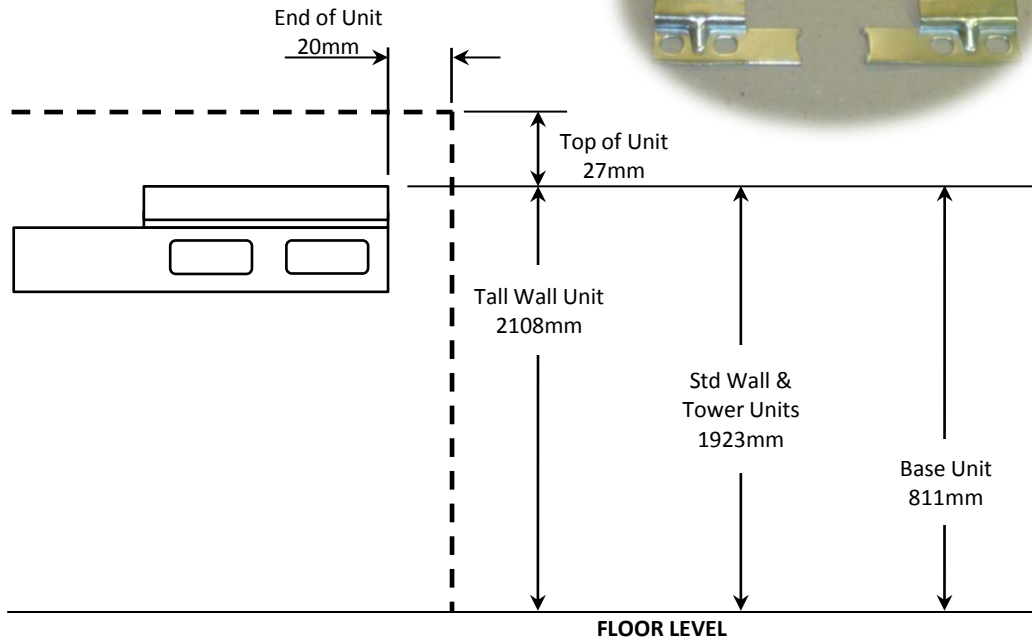

Wall Cabinet Bracket Adjustment

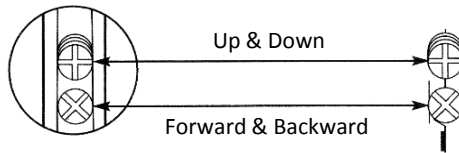

WALL BRACKET TYPE 'B'
Used with basin units, wc units, 350mm and 600mm drawer units

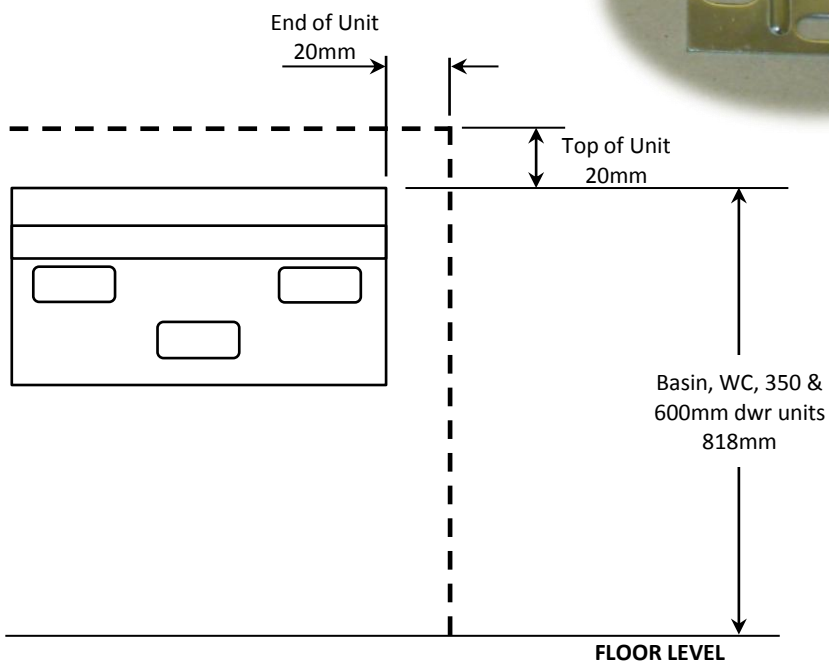

Installation Note - All edges should be fully sealed taking special care with work surface joints and edges, around basins and especially bath panels.

Adjustment Clip-On Hinge

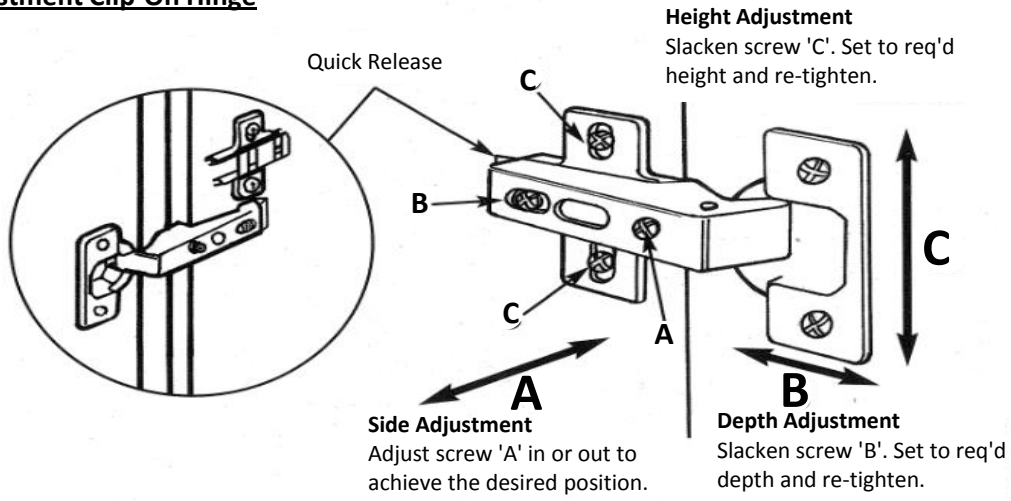

Adjustment 350 & 600mm Drawer Units

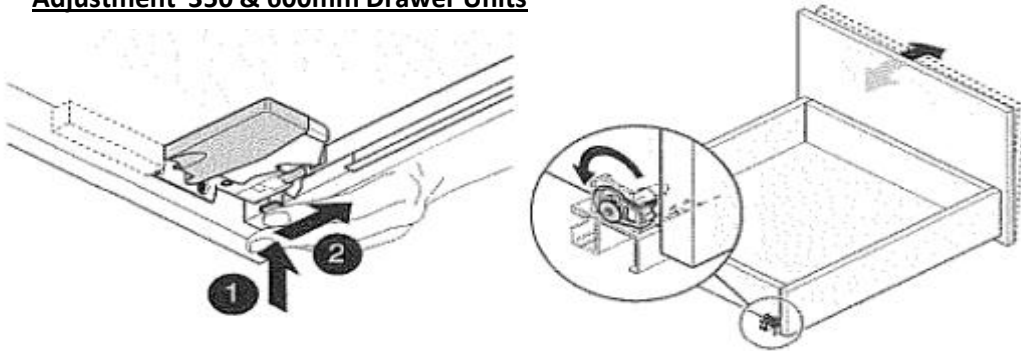

Height - Push grey lever up, then back. The further you push back, the higher the front rises (0 - 3mm)
Tilt - Twist cam at rear to achieve tilt of front (would normally only apply to very high fronts)

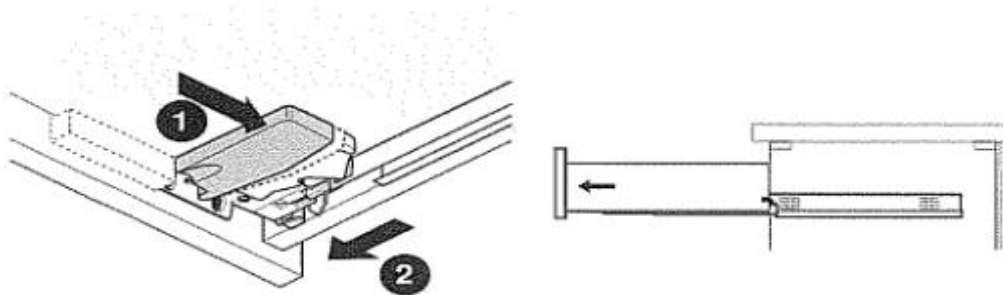

Insertion - Keep drawer base square to runner & push back, it will automatically lock in place.

Removal - Push the orange sections towards outside of drawer, do both at same time if applicable, then pull drawer.

Maintenance & Aftercare -

Water spillage, heavy condensation & cleaning with chemicals should be avoided. Clear up any spillage and wipe dry any excess moisture. Ensure adequate ventilation has been created thus minimising the effects of condensation. Surfaces should be cleaned with a damp cloth, mild solution of liquid soap in water and polished with a dry cloth. **Do not use abrasive cleaners, solvents or furniture polish.**